



Civic Centre,
Arnot Hill Park,
Arnold,
Nottinghamshire,
NG5 6LU

Agenda

Licensing Act Panel

Date: **Tuesday 27 June 2017**

Time: **2.00 pm**

Place: **Council Chamber**

For any further information please contact:

Lyndsey Parnell

Senior Democratic Services Officer

0115 901 3910

AGENDA

Page

- 1 Election of a Chair**
- 2 Apologies for Absence**
- 3 Declarations of Interest**
- 4 Consideration of an application of Eras Convenience Store Ltd for a Premised License under Licensing Act 2003 for premises at 1-3 Coningswath Road, Carlton. 5 - 38**

This page is intentionally left blank

ON THE APPLICATION OF ERAS CONVENIENCE STORE LTD FOR A PREMISES
LICENCE UNDER LICENSING ACT 2003 FOR THE PREMISES AT 1 – 3 CONINGSWATH
ROAD CARLTON NOTTINGHAM NG4 3SF

LICENSING ACT PANEL
HEARING: TUESDAY 27TH JUNE
AT 2.00PM

INDEX

No	Description	Date	Page No
1.	PROCEDURE		
1.1	Licensing Panel and Committee Procedure	Undated	1-4
1.2	Matters to be taken into account by the Panel	Undated	5-6
2.	APPLICATION		
2.1	Application for Premises Licence	28 April 2017	7-23
2.2	Plan of the Premises	Undated	24

3.	OBJECTIONS-INTERESTED PARTIES			
	3.1	Representation from Nottinghamshire Police	12 May 2017	25-26
	3.2	Representation from Jonathan Hand	29 May 2017	27-28
	3.3	Representation from Paul Murphy	26 May 2017	29
	3.4	Representation from Daryl Stocker	26 May 2017	30
	3.5	Representation from	26 May 2017	31
4.	OTHER INFORMATION			
	4.1	Plan of area	23 May 2017	32

LICENSING PANEL & COMMITTEE HEARING PROCEDURE

1. Upon notification that a matter is to be put before a Licensing Panel or the Committee, the applicant, interested parties and the responsible authorities shall within the time period provided for in the relevant regulations give notice to the Licensing Office stating
 - i. Whether they intend to be represented at the hearing
 - ii. The names and addresses of any witnesses that they intend to call
 - iii. The time estimate for their presentation/representations to the Committee
 - iv. Whether they consider a hearing to be unnecessary
2. Where a large number of interested parties are involved they will be encouraged to appoint a spokesperson or spokespersons so as to avoid duplication of evidence in so far as is possible.
3. Anyone invited to attend before a Panel or the Committee may bring legal or other professional representatives with them if they so wish. Advocates are, however, reminded that these are civil proceedings and inquisitorial rather than adversarial in nature. Aggressive advocacy is not encouraged and will not be tolerated.
4. Copies of the application and representations made by the parties will have been circulated to members prior to the hearing. However in appropriate cases, where a matter is to proceed to a hearing the applicant will be expected to supply a further 6 copies of the plan accompanying the application for use at the hearing. The hearing will concentrate solely on those areas of the application which are in dispute. The Authority is under an obligation to disregard information which is not relevant to the application, representation, or notice or to the licensing objectives. Advocates are therefore asked to be as succinct as possible and should be aware that the Chair may impose a time limit within which parties are to present their case.
5. Whilst additional material in support of the application, representation or notice may be taken into account by the Authority, such material should be provided and circulated by the producer to all parties concerned (including the Authority) as soon as possible before the hearing. Material produced at the hearing can only be admitted with the consent of all the other parties. The late production of material may lead to a hearing having to be adjourned and is discouraged. Additional material which reveals a new ground of representation or which is not relevant to the application, representation or notice lodged will be disregarded
6. Any party who intends to put additional written material before the Panel or the

Committee should provide 18 copies of that material to the licensing Office if the application is to go to the full Committee and 6 copies if the matter is to go before the Panel. Applicants should note that changes to application plans during the application process should be notified to the licensing Office as soon as possible and are likely to result in a new application having to be submitted. All relevant documentation received by the Authority will be sent to Members of the Panel/Committee and interested parties before the hearing if at all possible. Any failure to adhere to the requirements listed above may result in a case having to be adjourned and therefore delay the decision.

7. Where a party does not attend the hearing and is not represented the Authority may either adjourn the hearing if it is in the public interest to do so, or may continue with the hearing in the party's absence. If the latter option is followed the Committee/Panel will still consider any application, representation, or notice submitted by the absent party in so far as it is relevant.
8. The following procedure will ordinarily be followed at the Panel/Committee hearing:
 - i. The Chair will introduce themselves, other members and relevant officers. The Chair will also ask the applicant, interested parties and the responsible authorities to introduce themselves and any witnesses they wish to call. The Chair will then outline the procedure to be followed by the Panel/Committee and any time limits to be imposed on the presentation of cases.
 - ii. The applicant will be asked to present their case. Where a general presentation is made interested parties and the responsible authorities may ask questions at the end of that presentation. However, where witnesses are called, it is expected that each witness will give their evidence and then be open for questioning once their evidence has finished. The next witness will then give evidence. The order for asking questions will be:
 - Responsible Authorities
 - Interested parties
 - Panel/Committee Members
 - Legal advisor to the Panel/Committee (where appropriate)
 - iii. Responsible authorities, and interested parties will then be given an opportunity to present their representations. Once the representation has been presented and any evidence given, there will be an opportunity for questions to be asked firstly, by the applicant and then by other responsible authorities and interested parties, members and the legal advisor to the Panel/Committee. Where there is more than one body making representations to an application the order for the hearing of representations will normally be the responsible authorities followed by interested parties

- iv. Once all the evidence has been given responsible authorities, and interested parties will be given an opportunity to sum up their representations in the same order as they presented their case. The applicant will then be given an opportunity to sum up their case and have the final word.
 - v. Whilst Hearings will normally be conducted in Public the Panel/Committee does have powers of exclusion (which cover the public, the press, and even applicants, parties and their representatives) in appropriate circumstances. The Panel/Committee will however always discuss and make its decision on the application in private.
 - vi. The decision will normally be announced in public and transmitted in writing in accordance with the relevant rules and guidance. The decision may however be notified where applicable to the parties in writing at a subsequent date following the conclusion of the hearing.
9. If all parties agree and the Authority considers it appropriate, a hearing may be dispensed with. In some circumstances (where representations are not withdrawn), the Panel/Committee may still have to determine the application but will do so having considered the papers previously submitted. In such circumstances the Authority would also consider the terms of any "consent order" drawn up by the parties indicating terms upon which all of the relevant parties would be content that the application be granted.
10. Adjournments
- i. Due to the time constraints upon the Panels/Committee, applications for adjournments will only be granted where absolutely necessary
 - ii. Once a hearing date has been set it is for the parties to ensure that they attend or are represented. Hearings may proceed in the absence of a party and in such circumstances the party's original representations will be taken into account together with any further material in support of that representation which has been served on all parties before the day of the hearing.
 - iii. If it is not possible for a party or their witness to attend a hearing the Authority's preference would be for their representation to proceed by way of written evidence
 - iv. If it is necessary to make an application for an adjournment the party seeking the adjournment should seek the consent of all other parties to the application and notify the Licensing Office as soon as possible that an adjournment may be sought. If all parties agree the matter may be adjourned administratively.
 - v. If not agreed administratively the matter will remain listed before the Panel/ Committee to hear the application and determine whether to agree the adjournment or proceed.
 - vi. The Authority may adjourn proceedings of its own motion where it considers it necessary for its consideration of any application, representations or notice made or where it considers it to be in the interests of natural justice.
 - vii. Where an adjournment is granted all parties will be given notice of the adjournment and the new hearing date.

11. Applications to Extend Time Limits

- i. These may be dealt with administratively but will only be granted where it is necessary in the public interest.
- ii. Applications should be made to the Licensing Officer identifying:-
 - i. the licensing application and premises concerned,
 - ii. the person making the application for the time limit to be extended
 - iii. the time limit concerned,
 - iv. the reasons why that time limit cannot be complied with,
 - v. the extension sought,
 - vi. why it is believed that it would be in the interests of justice to grant the application, and
 - vii. whether all other parties have agreed to an extension of time.
- iii. Where an extension is granted all parties will be given notice of the extension.

THE PANEL'S CONSIDERATIONS

The Panel will disregard any information given or evidence produced, which is not relevant to the application or the promotion of the licensing objectives.

The Objectives are: -

- **The prevention of crime and disorder;**
- **Public safety;**
- **The prevention of public nuisance, and**
- **The protection of children from harm.**

Each objective is of equal importance.

The Panel will have regard to the national Guidance issued under Section 182 of the Licensing Act 2003 and the Borough Council's own Statement of Licensing Policy.

The Panel has a duty to act in a manner which is compatible with the Human Rights Act 1998.

A Licence is regarded as property for the purposes of the Human Rights Act 1998. Article 1 of the First Protocol states that:

"Every natural or legal person is entitled to the peaceful enjoyment of his possessions. No one shall be deprived of his possessions except in the public interest and subject to the conditions provided for by law and by the general principles of international law.

The preceding provisions shall not, however, in any way impair the right of a State to enforce such laws as it deems necessary to control the use of property in accordance with the general interest or to secure the payment of taxes or other contributions or penalties."

The Panel must also take into account the effect on local residents. Article 8 states:

"1. Everyone has the right to respect for his private and family life, his home and his correspondence.

2. There shall be no interference by a public authority with the exercise of this right except such as is in accordance with the law and is necessary in a democratic society in the interests of national security, public safety or the economic well-being of the country, for the prevention of disorder or crime, for the protection of health or morals, or for the protection of the rights and freedoms of others."

Three stage test to be applied: -

1. Is the interference in accordance with the law?
2. Is the interference necessary in a democratic society in pursuit of one of the legitimate aims set out above?
3. Is the decision proportionate i.e. striking a fair balance between the demands of the general interests of the community and the requirement to protect the individual's fundamental rights?

* required information

Section 1 of 21

You can save the form at any time and resume it later. You do not need to be logged in when you resume.

System reference

Not Currently In Use

This is the unique reference for this application generated by the system.

Your reference

ERAS CONVENIENCE STORE LTD

You can put what you want here to help you track applications if you make lots of them. It is passed to the authority.

Are you an agent acting on behalf of the applicant?

☒ Yes☐ No

Put "no" if you are applying on your own behalf or on behalf of a business you own or work for.

Applicant Details

* First name

GIGA

* Family name

ODEDRA

* E-mail

greenhill.licences@hotmail.com

Main telephone number

Include country code.

Other telephone number

☒ Indicate here if the applicant would prefer not to be contacted by telephone

Is the applicant:

☒ Applying as a business or organisation, including as a sole trader☐ Applying as an individual

A sole trader is a business owned by one person without any special legal structure. Applying as an individual means the applicant is applying so the applicant can be employed, or for some other personal reason, such as following a hobby.

Applicant Business

Is the applicant's business registered in the UK with Companies House?

☒ Yes☐ No

Note: completing the Applicant Business section is optional in this form.

Registration number

Business name

ERAS CONVENIENCE STORE LTD

If the applicant's business is registered, use its registered name.

VAT number

GB

977125492

Put "none" if the applicant is not registered for VAT.

Legal status

Private Limited Company

Continued from previous page...

Applicant's position in the business

DIRECTOR

Home country

United Kingdom

The country where the applicant's headquarters are.

Registered Address

Address registered with Companies House.

Building number or name

57

Street

NEW WALK

District

City or town

LEICESTER

County or administrative area

Postcode

LE17JB

Country

United Kingdom

Agent Details

* First name

ANIL

* Family name

BHAWSAR

* E-mail

greenhill.licences@hotmail.com

Main telephone number

Include country code.

Other telephone number

☐ Indicate here if you would prefer not to be contacted by telephone

Are you:

☐ An agent that is a business or organisation, including a sole trader

A sole trader is a business owned by one person without any special legal structure.

☒ A private individual acting as an agent

Your Address

Address official correspondence should be sent to.

* Building number or name

20

* Street

CRAIGHILL ROAD

District

* City or town

LEICESTER

County or administrative area

* Postcode

LE23FB

* Country

United Kingdom

Continued from previous page...

Section 2 of 21

PREMISES DETAILS

I/we, as named in section 1, apply for a premises licence under section 17 of the Licensing Act 2003 for the premises described in section 2 below (the premises) and I/we are making this application to you as the relevant licensing authority in accordance with section 12 of the Licensing Act 2003.

Premises Address

Are you able to provide a postal address, OS map reference or description of the premises?

☒ Address ☐ OS map reference ☐ Description

Postal Address Of Premises

Building number or name	1-3
Street	CONINGWATH ROAD
District	CARLTON
City or town	NOTTINGHAM
County or administrative area	
Postcode	NG4 3SF
Country	United Kingdom

Further Details

Telephone number	
Non-domestic rateable value of premises (£)	9,100

Section 3 of 21

APPLICATION DETAILS

In what capacity are you applying for the premises licence?

- ☐ An individual or individuals
- ☒ A limited company / limited liability partnership
- ☐ A partnership (other than limited liability)
- ☐ An unincorporated association
- ☐ Other (for example a statutory corporation)
- ☐ A recognised club
- ☐ A charity
- ☐ The proprietor of an educational establishment
- ☐ A health service body
- ☐ A person who is registered under part 2 of the Care Standards Act 2000 (c14) in respect of an independent hospital in Wales
- ☐ A person who is registered under Chapter 2 of Part 1 of the Health and Social Care Act 2008 in respect of the carrying on of a regulated activity (within the meaning of that Part) in an independent hospital in England
- ☐ The chief officer of police of a police force in England and Wales

Confirm The Following

- ☒ I am carrying on or proposing to carry on a business which involves the use of the premises for licensable activities
- ☐ I am making the application pursuant to a statutory function
- ☐ I am making the application pursuant to a function discharged by virtue of Her Majesty's prerogative

Section 4 of 21

NON INDIVIDUAL APPLICANTS

Provide name and registered address of applicant in full. Where appropriate give any registered number. In the case of a partnership or other joint venture (other than a body corporate), give the name and address of each party concerned.

Non Individual Applicant's Name

Name

ERAS CONVENIENCE STORE LTD

Details

Registered number (where applicable)

07014422

Description of applicant (for example partnership, company, unincorporated association etc)

Continued from previous page...

LIMITED COMPANY ,RETAIL CONVENIENCE STORE

Address

Building number or name

Street

District

City or town

County or administrative area

Postcode

Country

Contact Details

E-mail

Telephone number

Other telephone number

* Date of birth

dd mm yyyy

* Nationality Documents that demonstrate entitlement to work in the UK

[Add another applicant](#)

Section 5 of 21

OPERATING SCHEDULE

When do you want the premises licence to start? / /

dd mm yyyy

If you wish the licence to be valid only for a limited period, when do you want it to end / /

dd mm yyyy

Provide a general description of the premises

For example the type of premises, its general situation and layout and any other information which could be relevant to the licensing objectives. Where your application includes off-supplies of alcohol and you intend to provide a place for consumption of these off-supplies you must include a description of where the place will be and its proximity to the premises.

PROPOSING TO BE A RETAIL GROCERY CONVENIENCE STORE ,ALSO SELLING NEWSPAPERS AND ALCOHOL, CONSUMPTION OFF THE PREMISES. 7AM TO 11PM

Continued from previous page...

If 5,000 or more people are expected to attend the premises at any one time, state the number expected to attend

Section 6 of 21

PROVISION OF PLAYS

See guidance on regulated entertainment

Will you be providing plays?

☐ Yes

☒ No

Section 7 of 21

PROVISION OF FILMS

See guidance on regulated entertainment

Will you be providing films?

☐ Yes

☒ No

Section 8 of 21

PROVISION OF INDOOR SPORTING EVENTS

See guidance on regulated entertainment

Will you be providing indoor sporting events?

☐ Yes

☒ No

Section 9 of 21

PROVISION OF BOXING OR WRESTLING ENTERTAINMENTS

See guidance on regulated entertainment

Will you be providing boxing or wrestling entertainments?

☐ Yes

☒ No

Section 10 of 21

PROVISION OF LIVE MUSIC

See guidance on regulated entertainment

Will you be providing live music?

☐ Yes

☒ No

Section 11 of 21

PROVISION OF RECORDED MUSIC

See guidance on regulated entertainment

Will you be providing recorded music?

☐ Yes

☒ No

Section 12 of 21

PROVISION OF PERFORMANCES OF DANCE

See guidance on regulated entertainment

Will you be providing performances of dance?

Continued from previous page...

Section 13 of 21

PROVISION OF ANYTHING OF A SIMILAR DESCRIPTION TO LIVE MUSIC, RECORDED MUSIC OR PERFORMANCES OF DANCE

See guidance on regulated entertainment

Will you be providing anything similar to live music, recorded music or performances of dance?

☐ Yes

☒ No

Section 14 of 21

LATE NIGHT REFRESHMENT

Will you be providing late night refreshment?

☐ Yes

☒ No

Section 15 of 21

SUPPLY OF ALCOHOL

Will you be selling or supplying alcohol?

☒ Yes

☐ No

Standard Days And Timings

MONDAY

Start 07:00

End

Start

End

Give timings in 24 hour clock.
(e.g., 16:00) and only give details for the days
of the week when you intend the premises
to be used for the activity.

TUESDAY

Start 07:00

End

Start

End

WEDNESDAY

Start 07:00

End

Start

End

THURSDAY

Start 07:00

End

Start

End

FRIDAY

Start 07:00

End

Start

End

SATURDAY

Start 07:00

End

Start

End

Continued from previous page...

SUNDAY

Start 07:00

End

Start

End

Will the sale of alcohol be for consumption:

☐ On the premises ☒ Off the premises ☐ Both

If the sale of alcohol is for consumption on the premises select on, if the sale of alcohol is for consumption away from the premises select off. If the sale of alcohol is for consumption on the premises and away from the premises select both.

State any seasonal variations

For example (but not exclusively) where the activity will occur on additional days during the summer months.

Non-standard timings. Where the premises will be used for the supply of alcohol at different times from those listed in the column on the left, list below

For example (but not exclusively), where you wish the activity to go on longer on a particular day e.g. Christmas Eve.

State the name and details of the individual whom you wish to specify on the licence as premises supervisor

Name

First name

GIGA

Family name

OEDRA

Date of birth

dd mm yyyy

Continued from previous page...

Enter the contact's address

Building number or name

Street

District

City or town

County or administrative area

Postcode

Country

Personal Licence number
(if known)

Issuing licensing authority
(if known)



PROPOSED DESIGNATED PREMISES SUPERVISOR CONSENT

How will the consent form of the proposed designated premises supervisor be supplied to the authority?

- ☐ Electronically, by the proposed designated premises supervisor
- ☒ As an attachment to this application

Reference number for consent form (if known)

If the consent form is already submitted, ask the proposed designated premises supervisor for its 'system reference' or 'your reference'.

Section 16 of 21

ADULT ENTERTAINMENT

Highlight any adult entertainment or services, activities, or other entertainment or matters ancillary to the use of the premises that may give rise to concern in respect of children

Give information about anything intended to occur at the premises or ancillary to the use of the premises which may give rise to concern in respect of children, regardless of whether you intend children to have access to the premises, for example (but not exclusively) nudity or semi-nudity, films for restricted age groups etc gambling machines etc.

NONE

Section 17 of 21

HOURS PREMISES ARE OPEN TO THE PUBLIC

Standard Days And Timings

MONDAY

Start

End

Start

End

Give timings in 24 hour clock.
(e.g., 16:00) and only give details for the days
of the week when you intend the premises
to be used for the activity.

Continued from previous page...

TUESDAY

Start End

Start End

WEDNESDAY

Start End

Start End

THURSDAY

Start End

Start End

FRIDAY

Start End

Start End

SATURDAY

Start End

Start End

SUNDAY

Start End

Start End

State any seasonal variations

For example (but not exclusively) where the activity will occur on additional days during the summer months.

Non standard timings. Where you intend to use the premises to be open to the members and guests at different times from those listed in the column on the left, list below

For example (but not exclusively), where you wish the activity to go on longer on a particular day e.g. Christmas Eve.

Section 18 of 21

LICENSING OBJECTIVES

Describe the steps you intend to take to promote the four licensing objectives:

a) General – all four licensing objectives (b,c,d,e)

Continued from previous page...

List here steps you will take to promote all four licensing objectives together.

The business will take into account the licence act 2003 and alcohol will be sold with all due care.
Cameras ,refusal of sale of alcohol records will be kept. Posters indicating underage sales warnings to customers

b) The prevention of crime and disorder

PROVIDE A CAMERA SYSTEM THAT COVERS 31 DAYS RECORDING. THERE WILL BE A MINIMUM OF 10 CAMERAS .
RECORDINGS WILL BE MADE AVAILABLE TO POLICE,SHOULD THEY BE REQUIRED.
ALL STAFF SERVING ALCOHOL WILL BE TRAINED EVERY 12 MONTHS ,
TRAINING BOOK WILL BE KEPT BEHIND BAR COUNTER.
A REFUSALS BOOK WILL BE USED TO RECORD DETAILS , KEPT BEHIND BAR COUNTER.
PHOTO ID WILL BE CHECKED TO PREVENT UNDER AGE SALES. ALCOHOL SALES MADE BY USING TO CHALLENGE 21
POLICY.

c) Public safety

SAFETY CHECKS INSIDE AND OUTSIDE OF PREMISE WILL BE MADE REGULARLY.
USE ADEQUATE AND APPROPRIATE LIGHTING. MAKE SURE ALL AREAS AVAILABLE TO CUSTOMERS ARE CLEAN AND CLEAR.

d) The prevention of public nuisance

ENSURE BINS ARE EMPTIED BETWEEN 7AM AND 11PM.
REFUSE TO SERVE CUSTOMERS CAUSING ANTI SOCIAL BEHAVIOUR

e) The protection of children from harm

TO USE CHALLENGE 21 SCHEME. TO WATCH FOR FAKE I.D.
LOG REGISTER/REFUSAL BOOK AND TRAINING BOOK WILL BE USED AND KEPT BEHIND COUNTER
USE 'NO I.D. NO SALE' POSTERS . ACCEPT ONLY GOVERNMENT APPROVED I.D. PROMOTE AND OBTAIN 'PASS' LITERATURE
FOR I.D. PURPOSES, PROOF OF AGE SCHEME.

Section 19 of 21

NOTES ON DEMONSTRATING ENTITLEMENT TO WORK IN THE UK

Continued from previous page...

Entitlement to work/immigration status for individual applicants and applications from partnerships which are not limited liability partnerships:

A licence may not be held by an individual or an individual in a partnership who is resident in the UK who:

- does not have the right to live and work in the UK; or
- is subject to a condition preventing him or her from doing work relating to the carrying on of a licensable activity.

Any premises licence issued in respect of an application made on or after 6 April 2017 will become invalid if the holder ceases to be entitled to work in the UK.

Applicants must demonstrate that they have an entitlement to work in the UK and are not subject to a condition preventing them from doing work relating to the carrying on of a licensable activity. They do this by providing with this application copies or scanned copies of the following documents (which do not need to be certified).

Documents which demonstrate entitlement to work in the UK

- An expired or current passport showing the holder, or a person named in the passport as the child of the holder, is a British citizen or a citizen of the UK and Colonies having the right of abode in the UK [please see note below about which sections of the passport to copy].
- An expired or current passport or national identity card showing the holder, or a person named in the passport as the child of the holder, is a national of a European Economic Area country or Switzerland.
- A Registration Certificate or document certifying permanent residence issued by the Home Office to a national of a European Economic Area country or Switzerland.
- A Permanent Residence Card issued by the Home Office to the family member of a national of a European Economic Area country or Switzerland.
- A **current** Biometric Immigration Document (Biometric Residence Permit) issued by the Home Office to the holder indicating that the person named is allowed to stay indefinitely in the UK, or has no time limit on their stay in the UK.
- A **current** passport endorsed to show that the holder is exempt from immigration control, is allowed to stay indefinitely in the UK, has the right of abode in the UK, or has no time limit on their stay in the UK.
- A **current** Immigration Status Document issued by the Home Office to the holder with an endorsement indicating that the named person is allowed to stay indefinitely in the UK or has no time limit on their stay in the UK, **when produced in combination with** an official document giving the person's permanent National Insurance number and their name issued by a Government agency or a previous employer.
- A **full** birth or adoption certificate issued in the UK which includes the name(s) of at least one of the holder's parents or adoptive parents, **when produced in combination with** an official document giving the person's permanent National Insurance number and their name issued by a Government agency or a previous employer.
- A birth or adoption certificate issued in the Channel Islands, the Isle of Man or Ireland **when produced in combination with** an official document giving the person's permanent National Insurance number and their name issued by a Government agency or a previous employer.
- A certificate of registration or naturalisation as a British citizen, **when produced in combination with** an official document giving the person's permanent National Insurance number and their name issued by a Government agency or a previous employer.
- A **current** passport endorsed to show that the holder is allowed to stay in the UK and is currently allowed to work and is not subject to a condition preventing the holder from doing work relating to the carrying on of a licensable activity.

Continued from previous page...

- A **current** Biometric Immigration Document (Biometric Residence Permit) issued by the Home Office to the holder which indicates that the named person can currently stay in the UK and is allowed to work relation to the carrying on of a licensable activity.
- A **current** Residence Card issued by the Home Office to a person who is not a national of a European Economic Area state or Switzerland but who is a family member of such a national or who has derivative rights or residence.
- A **current** Immigration Status Document containing a photograph issued by the Home Office to the holder with an endorsement indicating that the named person may stay in the UK, and is allowed to work and is **not** subject to a condition preventing the holder from doing work relating to the carrying on of a licensable activity **when produced in combination with** an official document giving the person's permanent National Insurance number and their name issued by a Government agency or a previous employer.
- A Certificate of Application, **less than 6 months old**, issued by the Home Office under regulation 17(3) or 18A (2) of the Immigration (European Economic Area) Regulations 2006, to a person who is not a national of a European Economic Area state or Switzerland but who is a family member of such a national or who has derivative rights of residence.
- Reasonable evidence that the person has an outstanding application to vary their permission to be in the UK with the Home Office such as the Home Office acknowledgement letter or proof of postage evidence, or reasonable evidence that the person has an appeal or administrative review pending on an immigration decision, such as an appeal or administrative review reference number.
- Reasonable evidence that a person who is not a national of a European Economic Area state or Switzerland **but** who is a family member of such a national or who has derivative rights of residence in exercising treaty rights in the UK including:-
 - evidence of the applicant's own identity – such as a passport,
 - evidence of their relationship with the European Economic Area family member – e.g. a marriage certificate, civil partnership certificate or birth certificate, and
 - evidence that the European Economic Area national has a right of permanent residence in the UK or is one of the following if they have been in the UK for more than 3 months:
 - (i) working e.g. employment contract, wage slips, letter from the employer,
 - (ii) self-employed e.g. contracts, invoices, or audited accounts with a bank,
 - (iii) studying e.g. letter from the school, college or university and evidence of sufficient funds; or
 - (iv) self-sufficient e.g. bank statements.

Family members of European Economic Area nationals who are studying or financially independent must also provide evidence that the European Economic Area national and any family members hold comprehensive sickness insurance in the UK. This can include a private medical insurance policy, an EHIC card or an S1, S2 or S3 form.

Original documents must not be sent to licensing authorities. If the document copied is a passport, a copy of the following pages should be provided:-

- (i) any page containing the holder's personal details including nationality;
- (ii) any page containing the holder's photograph;
- (iii) any page containing the holder's signature;
- (iv) any page containing the date of expiry; and
- (v) any page containing information indicating the holder has permission to enter or remain in the UK and is permitted to work.

If the document is not a passport, a copy of the whole document should be provided.

Your right to work will be checked as part of your licensing application and this could involve us checking your immigration status with the Home Office. We may otherwise share information with the Home Office. Your licence application will not be determined until you have complied with this guidance.

Section 20 of 21

NOTES ON REGULATED ENTERTAINMENT

Continued from previous page...

In terms of specific **regulated entertainments** please note that:

- Plays: no licence is required for performances between 08:00 and 23.00 on any day, provided that the audience does not exceed 500.
- Films: no licence is required for 'not-for-profit' film exhibition held in community premises between 08.00 and 23.00 on any day provided that the audience does not exceed 500 and the organiser (a) gets consent to the screening from a person who is responsible for the premises; and (b) ensures that each such screening abides by age classification ratings.
- Indoor sporting events: no licence is required for performances between 08.00 and 23.00 on any day, provided that the audience does not exceed 1000.
- Boxing or Wrestling Entertainment: no licence is required for a contest, exhibition or display of Greco-Roman wrestling, or freestyle wrestling between 08.00 and 23.00 on any day, provided that the audience does not exceed 1000. Combined fighting sports – defined as a contest, exhibition or display which combines boxing or wrestling with one or more martial arts – are licensable as a boxing or wrestling entertainment rather than an indoor sporting event.
- Live music: no licence permission is required for:
 - o a performance of unamplified live music between 08.00 and 23.00 on any day, on any premises.
 - o a performance of amplified live music between 08.00 and 23.00 on any day on premises authorised to sell alcohol for consumption on those premises, provided that the audience does not exceed 500.
 - o a performance of amplified live music between 08.00 and 23.00 on any day, in a workplace that is not licensed to sell alcohol on those premises, provided that the audience does not exceed 500.
 - o a performance of amplified live music between 08.00 and 23.00 on any day, in a church hall, village hall, community hall, or other similar community premises, that is not licensed by a premises licence to sell alcohol, provided that (a) the audience does not exceed 500, and (b) the organiser gets consent for the performance from a person who is responsible for the premises.
 - o a performance of amplified live music between 08.00 and 23.00 on any day, at the non-residential premises of (i) a local authority, or (ii) a school, or (iii) a hospital, provided that (a) the audience does not exceed 500, and (b) the organiser gets consent for the performance on the relevant premises from: (i) the local authority concerned, or (ii) the school or (iii) the health care provider for the hospital.
- Recorded Music: no licence permission is required for:
 - o any playing of recorded music between 08.00 and 23.00 on any day on premises authorised to sell alcohol for consumption on those premises, provided that the audience does not exceed 500.
 - o any playing of recorded music between 08.00 and 23.00 on any day, in a church hall, village hall, community hall, or other similar community premises, that is not licensed by a premises licence to sell alcohol, provided that (a) the audience does not exceed 500, and (b) the organiser gets consent for the performance from a person who is responsible for the premises.
 - o any playing of recorded music between 08.00 and 23.00 on any day, at the non-residential premises of (i) a local authority, or (ii) a school, or (iii) a hospital, provided that (a) the audience does not exceed 500, and (b) the organiser gets consent for the performance on the relevant premises from: (i) the local authority concerned, or (ii) the school proprietor or (iii) the health care provider for the hospital.

Continued from previous page...

- Dance: no licence is required for performances between 08.00 and 23.00 on any day, provided that the audience does not exceed 500. However, a performance which amounts to adult entertainment remains licensable.
- Cross activity exemptions: no licence is required between 08.00 and 23.00 on any day, with no limit on audience size for:
 - o any entertainment taking place on the premises of the local authority where the entertainment is provided by or on behalf of the local authority;
 - o any entertainment taking place on the hospital premises of the health care provider where the entertainment is provided by or on behalf of the health care provider;
 - o any entertainment taking place on the premises of the school where the entertainment is provided by or on behalf of the school proprietor; and
 - o any entertainment (excluding films and a boxing or wrestling entertainment) taking place at a travelling circus, provided that (a) it takes place within a moveable structure that accommodates the audience, and (b) that the travelling circus has not been located on the same site for more than 28 consecutive days.

Section 21 of 21

PAYMENT DETAILS

This fee must be paid to the authority. If you complete the application online, you must pay it by debit or credit card.

Premises Licence Fees are determined by the non domestic rateable value of the premises.

To find out a premises non domestic rateable value go to the Valuation Office Agency site at http://www.voa.gov.uk/business_rates/index.htm

Band A - No RV to £4300	£100.00
Band B - £4301 to £33000	£190.00
Band C - £33001 to £8700	£315.00
Band D - £87001 to £12500	£450.00*
Band E - £125001 and over	£635.00*

*If the premises rateable value is in Bands D or E and the premises is primarily used for the consumption of alcohol on the premises then you are required to pay a higher fee

Band D - £87001 to £12500	£900.00
Band E - £125001 and over	£1,905.00

There is an exemption from the payment of fees in relation to the provision of regulated entertainment at church halls, chapel halls or premises of a similar nature, village halls, parish or community halls, or other premises of a similar nature. The costs associated with these licences will be met by central Government. If, however, the licence also authorises the use of the premises for the supply of alcohol or the provision of late night refreshment, a fee will be required.

Schools and sixth form colleges are exempt from the fees associated with the authorisation of regulated entertainment where the entertainment is provided by and at the school or college and for the purposes of the school or college.

If you operate a large event you are subject to ADDITIONAL fees based upon the number in attendance at any one time

Capacity 5000-9999	£1,000.00
Capacity 10000 -14999	£2,000.00
Capacity 15000-19999	£4,000.00
Capacity 20000-29999	£8,000.00
Capacity 30000-39000	£16,000.00
Capacity 40000-49999	£24,000.00
Capacity 50000-59999	£32,000.00
Capacity 60000-69999	£40,000.00
Capacity 70000-79999	£48,000.00

Continued from previous page...

Capacity 80000-89999 £56,000.00
Capacity 90000 and over £64,000.00

* Fee amount (£) 190.00

DECLARATION

* I/we understand it is an offence, liable on conviction to a fine up to level 5 on the standard scale, under section 158 of the licensing act 2003, to make a false statement in or in connection with this application.

☒ Ticking this box indicates you have read and understood the above declaration

This section should be completed by the applicant, unless you answered "Yes" to the question "Are you an agent acting on behalf of the applicant?"

* Full name ANIL BHAWSAR

* Capacity AGENT

* Date 28 / 04 / 2017
dd mm yyyy

Add another signatory

Once you're finished you need to do the following:

1. Save this form to your computer by clicking file/save as...

2. Go back to <https://www.gov.uk/apply-for-a-licence/premises-licence/gedling/apply-1> to upload this file and continue with your application.

Don't forget to make sure you have all your supporting documentation to hand.

IT IS AN OFFENCE LIABLE TO SUMMARY CONVICTION TO A FINE OF ANY AMOUNT UNDER SECTION 158 OF THE LICENSING ACT 2003, TO MAKE A FALSE STATEMENT IN OR IN CONNECTION WITH THIS APPLICATION

IT IS AN OFFENCE UNDER SECTION 24B OF THE IMMIGRATION ACT 1971 FOR A PERSON TO WORK WHEN THEY KNOW, OR HAVE REASONABLE CAUSE TO BELIEVE, THAT THEY ARE DISQUALIFIED FROM DOING SO BY REASON OF THEIR IMMIGRATION STATUS. THOSE WHO EMPLOY AN ADULT WITHOUT LEAVE OR WHO IS SUBJECT TO CONDITIONS AS TO EMPLOYMENT WILL BE LIABLE TO A CIVIL PENALTY UNDER SECTION 15 OF THE IMMIGRATION, ASYLUM AND NATIONALITY ACT 2006 AND PURSUANT TO SECTION 21 OF THE SAME ACT, WILL BE COMMITTING AN OFFENCE WHERE THEY DO SO IN THE KNOWLEDGE, OR WITH REASONABLE CAUSE TO BELIEVE, THAT THE EMPLOYEE IS DISQUALIFIED

OFFICE USE ONLY

Applicant reference number	ERAS CONVENIENCE STORE LTD
Fee paid	
Payment provider reference	
ELMS Payment Reference	
Payment status	
Payment authorisation code	
Payment authorisation date	
Date and time submitted	
Approval deadline	
Error message	
Is Digitally signed	<input type="checkbox"/>

< Previous [1](#) [2](#) [3](#) [4](#) [5](#) [6](#) [7](#) [8](#) [9](#) [10](#) [11](#) [12](#) [13](#) [14](#) [15](#) [16](#) [17](#) [18](#) [19](#) [20](#) [21](#) Next >

1-3 CONINGSWATH ROAD CARLTON, NOTTINGHAM, NG4 3SF

SCALE 1:100

1 CM = 1M.

- X - CHAEM POINTS
- ⊠ - Proposed Alcohol area
- - Concealed Area
- ⊖ - Fire Extinguisher

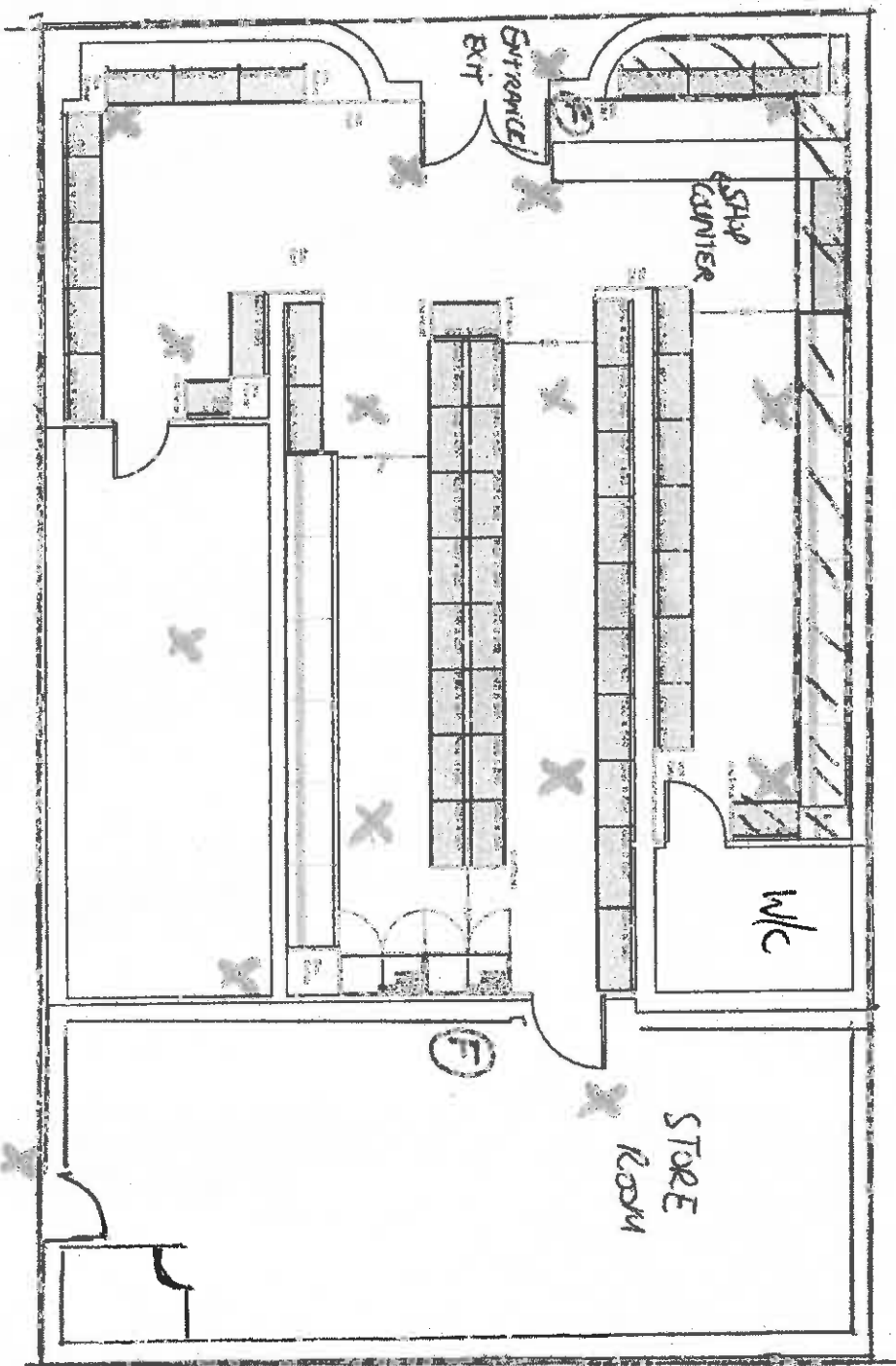

CONSTRUCTION NOTES

1. The proposed shop and store are to be constructed in accordance with the Building Regulations 2010 and the Building Regulations 2010 (Approved Document A) and the Building Regulations 2010 (Approved Document B).

2. The proposed shop and store are to be constructed in accordance with the Building Regulations 2010 and the Building Regulations 2010 (Approved Document A) and the Building Regulations 2010 (Approved Document B).

3. The proposed shop and store are to be constructed in accordance with the Building Regulations 2010 and the Building Regulations 2010 (Approved Document A) and the Building Regulations 2010 (Approved Document B).

PROPOSITION & STANDARD DESIGN CONDITIONS

The proposed shop and store are to be constructed in accordance with the Building Regulations 2010 and the Building Regulations 2010 (Approved Document A) and the Building Regulations 2010 (Approved Document B).

PROPOSITION & STANDARD DESIGN CONDITIONS

The proposed shop and store are to be constructed in accordance with the Building Regulations 2010 and the Building Regulations 2010 (Approved Document A) and the Building Regulations 2010 (Approved Document B).

PROPOSITION & STANDARD DESIGN CONDITIONS

The proposed shop and store are to be constructed in accordance with the Building Regulations 2010 and the Building Regulations 2010 (Approved Document A) and the Building Regulations 2010 (Approved Document B).

PROPOSITION & STANDARD DESIGN CONDITIONS

The proposed shop and store are to be constructed in accordance with the Building Regulations 2010 and the Building Regulations 2010 (Approved Document A) and the Building Regulations 2010 (Approved Document B).

TRANSFORMATION

The proposed shop and store are to be constructed in accordance with the Building Regulations 2010 and the Building Regulations 2010 (Approved Document A) and the Building Regulations 2010 (Approved Document B).

Rachel Pentlow

From: Rhodes-Best, Susan [REDACTED]
Sent: 20 May 2017 11:47
To: Rachel Pentlow; [REDACTED]
Subject: FW: ERAS CONVENIENCE STORE 1-3 Coningwath Road CARLTON - PREMISE LICENCE APPLICATION
Attachments: ERAS Off Licence Carlton.doc
Importance: High

Good Morning,

Please see the agreed attached conditions for ERAS off licence.

Regards

Susie

Susie Rhodes-Best
Senior Licensing Officer
County Liquor Licensing
Mansfield Police Station
Great Central Road
Mansfield
Nottinghamshire
NG18 2HQ
101 (8053378)
[REDACTED]

From: Horton, Paul
Sent: 12 May 2017 12:48
To: Rhodes-Best, Susan
Subject: FW: ERAS CONVENIENCE STORE 1-3 Coningwath Road CARLTON - PREMISE LICENCE APPLICATION
Importance: High

Susie,

Please see below and attached re conditions agreed with the applicant

Paul

Paul Horton (7271)
Police Licensing Enforcement Officer
County Division

Local Policing Unit (Licensing)
Nottinghamshire Police
Mansfield Police Station
Great Central Road
Mansfield
Nottinghamshire NG18 2HQ

Tel: 101

Mansfield
Nottinghamshire NG18 2HQ

Tel: 101

Fax: 01623 483968

Unless otherwise stated please treat as restricted

Internet e-mail is not to be treated as a secure means of communication. Nottinghamshire Police monitors all Internet e-mail activity and content. This communication is intended for the addressee(s) only. Please notify the sender if received in error. Unauthorised use or disclosure of the content may be unlawful. There is no intent, by Nottinghamshire Police, that this e-mail should constitute a legally binding document, nor do opinions expressed herein necessarily represent official policy.

Find out about Nottinghamshire Police by visiting www.nottinghamshire.police.uk

Internet e-mail is not to be treated as a secure means of communication. Nottinghamshire Police monitors all Internet e-mail activity and content. This communication is intended for the addressee(s) only. Please notify the sender if received in error. Unauthorised use or disclosure of the content may be unlawful. There is no intent, by Nottinghamshire Police, that this e-mail should constitute a legally binding document, nor do opinions expressed herein necessarily represent official policy.

Find out about Nottinghamshire Police by visiting www.nottinghamshire.police.uk

<ERAS Off Licence Carlton.doc>

This email has been scanned by the Symantec Email Security.cloud service.
For more information please visit <http://www.symanteccloud.com>

Internet e-mail is not to be treated as a secure means of communication. Nottinghamshire Police monitors all Internet e-mail activity and content. This communication is intended for the addressee(s) only. Please notify the sender if received in error. Unauthorised use or disclosure of the content may be unlawful. There is no intent, by Nottinghamshire Police, that this e-mail should constitute a legally binding document, nor do opinions expressed herein necessarily represent official policy.

Find out about Nottinghamshire Police by visiting www.nottinghamshire.police.uk

Rachel Pentlow

From: Jill Bradley
Sent: 30 May 2017 15:55
To: Rachel Pentlow
Subject: FW: Objection email for an Alcohol License

From: Enquiries
Sent: 30 May 2017 15:36
To: Licencesdbs Handover
Subject: FW: Objection email for an Alcohol License

From: Jonathan [REDACTED]
Sent: 29 May 2017 13:02
To: licensing
Subject: Objection email for an Alcohol License

To whom this may concern

With regards to a notice of application for a premises licence under the licensing act 2003 at 1-3 Coningswath Road, Carlton Nottingham NG4 3SF

I would like to make an objection to this application for the following reasons:

The premises in question is next door to my residential address.

This is a highly build up residential area which has 2 large retail outlets with in close proximity, Tesco in one direction and the Co-op in the other. There is also a smaller outlet just down the road, so there is no need for a further outlet selling alcohol.

In addition the hours of opening (Monday-Sunday from 0700-2300hrs) in this residential area would be disruptive to immediate and surrounding residents, with the extra traffic, noise and litter generated.

It would also be sited very close to a school which will encourage children to loiter, using the frontage as a gathering place and to purchase alcohol. The area is very congested in the morning and afternoons when children are either being dropped off or picked up during school opening hours.

The premises in question is at the junction of the two busy roads and on main bus route, and there would be potential risk of accidents for both pedestrians and vehicular. I have already been a witness to 13 year old being hit and thrown high into the air by a car and do not want to see this again, should you wish to check this the incident in question happened on 4th September 2015 and the driver was found guilty of causing serious injury by dangerous driving.

Can you please confirm by return that you have received this email.

Regards

Jonathan Hand

271 Cavendish Road

Carlton

Nottingham

NG4 3SA

Rachel Pentlow

From: Enquiries
Sent: 26 May 2017 16:05
To: Licencesdbs Handover
Subject: FW: Objection email for an Alcohol License

Importance: High

From: P&J [REDACTED]
Sent: 26 May 2017 15:50
To: licensing
Subject: Objection email for an Alcohol License
Importance: High

To whom this may concern

With regards to a notice of application for a premises licence under the licensing act 2003 at 1-3 Coningswath Road, Carlton Nottingham NG4 3SF

I would like to make an objection to this application for the following reasons:

The premises in question is next door to my residential address.

This is a highly build up residential area which has 2 large retail outlets with in close proximity, Tesco in one direction and the Co-op in the other. There is also a smaller outlet just down the road, so there is no need for a further outlet selling alcohol.

In addition the hours of opening (Monday-Sunday from 0700-2300hrs) in this residential area would be disruptive to immediate and surrounding residents, with the extra traffic, noise and litter generated.

It would also be sited very close to a school which will encourage children to loiter, using the frontage as a gathering place and to purchase alcohol. The area is very congested in the morning and afternoons when children are either being dropped off or picked up during school opening hours.

The premises in question is at the junction of the two busy roads and on main bus route, and there would be potential risk of accidents for both pedestrians and vehicular.

Can you please confirm by return that you have received this email.

Regards
Paul W Murphy
271 Cavendish Road
Carlton
Nottingham
NG4 3SA

RECEIVED
30 MAY 2017

251 Cavendish Road
Carlton
Nottingham
NG4 3SA

26th May 2017

Dear Sir,

I would like to make an objection to the application for an alcohol license at 1-3 Coningswath Road Carlton.

This is a residential area which has large retail outlets with in close proximity, Tesco in one direction and the Co-op in the other. There is also a smaller outlet just down the road, so there is no need for a further outlet selling alcohol.

In addition the hours of opening in a residential area would be disruptive to the general area and immediate residents, with the extra traffic, noise and litter generated. It is also sited very close to a school which will encourage children to loiter, using the frontage as a gathering place and to purchase alcohol.

The location being at the junction of the two roads and on the bus route, there is a potential risk of accidents for both pedestrians and vehicular.

Yours truly,

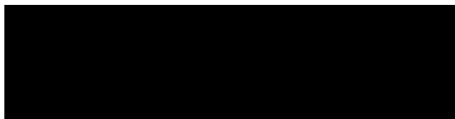

Daryl Stocker

RECEIVED

30 MAY 2017

251 Cavendish Road
Carlton
Nottingham
NG4 3SA

26th May 2017

Dear Sir,

I would like to make an objection to the application for an alcohol license at 1-3 Coningswath Road Carlton.

This is a residential area which has large retail outlets with in close proximity, Tesco in one direction and the Co-op in the other. There is also a smaller outlet just down the road, so there is no need for a further outlet selling alcohol.

In addition the hours of opening in a residential area would be disruptive to the general area and immediate residents, with the extra traffic, noise and litter generated. It is also sited very close to a school which will encourage children to loiter, using the frontage as a gathering place and to purchase alcohol.

The location being at the junction of the two roads and on the bus route, there is a potential risk of accidents for both pedestrians and vehicular.

Yours truly,

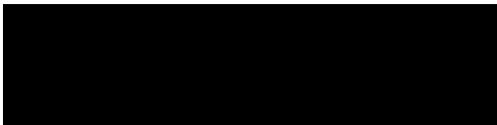
A black rectangular box redacting the signature of Keith Ashworth.

Keith Ashworth



Contains OS data © Crown Copyright and database right 2017